

CONCORD HOSPITAL

YARALLA HOUSE
Dame Eadith Walker
Estate

THE DRIVE



YARALLA BAY

CONCORD CENTRE FOR MENTAL HEALTH

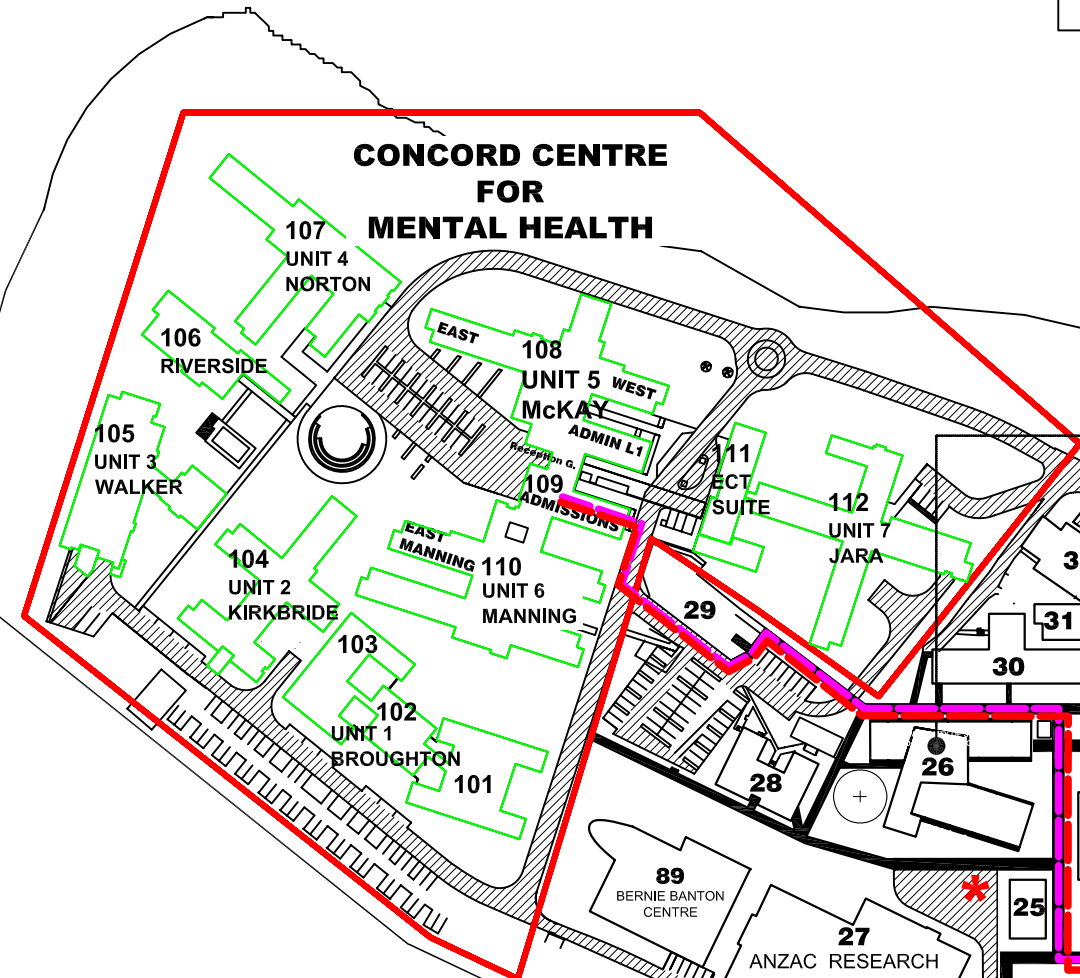

UNIVERSITY OF SYDNEY
CONCORD MEDICAL EDUCATION CENTRE

HELIPAD

VETERAN
DISABLED
PARKING

CSSS
WAREHOUSE
79

Cottages

TO YARALLA HOUSE
DAME EDITH WALKER ESTATE

WARD 65

WARD 64

ENTRANCE
FOR
DISABLED
PARKING

TO YARALLA
HOUSE
DAME EDITH
WALKER ESTATE

CURRAWANG STREET

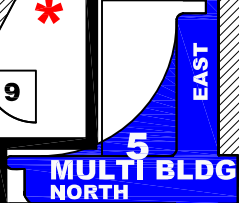

Rivendell
Adolescent
Unit

ANZAC RESEARCH
INSTITUTE

LEGEND

WALKWAYS

ROADS

BUILDING No's

DISABLED PARKING

PATIENT ACCESS ROUTE
EMERGENCY TO MENTAL HEALTH

PARRAMATTA RIVER

BRAY'S OR HORSESHOE BAY

CLINICAL SCIENCES
BUILDING

DISCHARGE LOUNGE
Patient Pick Up

CAFETERIA



NSW
INSTITUTE
OF SPORTS
MEDICINE

MAIN
HOSPITAL CARPARK

MAIN
ENTRANCE

BUS ROUTES

458 Strathfield - Burwood - Ryde
461 City - Ryde
460 Five Dock - Concord Hospital

VISITING HOURS

11.00AM - 1.30PM

3.00PM - 8.00PM



Concord Hospital is a smoke free environment.
Smoking is not permitted by anyone within the
premises or grounds.



22 OCT 2013

LOCATION	BLDG	LEVEL	LOCATION	BLDG	LEVEL
A			I		
ACCOMMODATION - GUEST	B75	3	IMMUNOLOGY & ALLERGY	4	
ADMISSIONS	3	GF	INFORMATION SYSTEMS DEPT.	33 & 34	
AGED COMMUNITY SERVICES	19		INNER WEST LIVE AT HOME PROGRAM	19	
ANAESTHESIA & PAIN MANAGEMENT	76	1	INTERPRETER SERVICES	76	1
ANATOMICAL PATHOLOGY	Multi	GF - North			
ANZAC RESEARCH INSTITUTE	27		J		
B			JUICE BAR	Multi	LG - North
BANK ATM	3	GF			
BIOMEDICAL ENGINEERING	80		K		
BURNS OFFICES (STATEWIDE SERVICES)	76	1	KINDILAN (Cottage)	82	GATE 4
C			L		
CAFETERIA	6		LEARNING & DEVELOPMENT UNIT	20	
CASHIERS OFFICE	3	GF	LIBRARY	26	
CENTRE FOR EDUCATION & RESEARCH ON AGEING (CERA)	18		LINEN SERVICE AND UNIFORM STORE	86	
CENTRAL SYDNEY SUPPLY SERVICE (CSSS)	79		M		
CHAPEL	9		MAIL CENTRE	60	
CHARCOT - MARIE - TOOTH ASSOCIATION	22		MEDICAL ALLOCATIONS & DEVELOPMENT UNIT (MADU)	76	GF
CHEMIST	2		MEDICAL CENTRE	2	
CHILD CARE CENTRE (Yaralla)	84		MEDICAL CENTRE CAFE	2	GF
CLINICAL SCHOOL (UNIVERSITY OF SYDNEY)	20		MEDICAL ONCOLOGY (Sydney Cancer Centre)	Multi	GF - East
CLINICAL SCIENCES BUILDING	20A		MEDICAL RECORDS DEPARTMENT	63	
COMMERCIAL SERVICES SUPPORT UNIT (CSSU)	73		MEDICAL STUDENTS RECREATION AREA	24	
COMMONWEALTH CARER RESPITE CENTRE	19		METABOLIC REHABILITATION	2	6
COMMUNITY NURSES	19		MICROBIOLOGY & INFECTIOUS DISEASES	3	GF - South
COMPUTER CENTRE	58		MOLECULAR GENETICS LAB	20A	
CONFERENCE ROOMS 1 & 2	Multi	LG - North	MORTUARY	59	
CONFERENCE ROOM 3	2	7	MUSEUM - EM LANE NURSES	8A	

CLINICS

AGED & EXTENDED CARE (AECD)	12		N		
ANDROLOGY	22		NEWSAGENT	7	
AUDIOLOGY (Medical Centre)	2	1	NSW INSTITUTE OF SPORTS MEDICINE	87	
CARDIAC CATHETERISATION SUITE	Multi	3 - West	NUCLEAR MEDICINE	3	1
CARDIOLOGY	Multi	3 - West	O		
COGNITIVE DISORDERS	12		OCCUPATIONAL HEALTH & SAFETY UNIT	22	
DENTAL	21		OCCUPATIONAL THERAPY	21 & 22A	
DERMATOLOGY	2	5	P		
ECG	Multi	3 - West	PALLIATIVE CARE SERVICE	75	L2
ENDOCRINOLOGY & METABOLISM	2	6	PATIENT ENQUIRIES	3	GF
ENDOSCOPY & COLORECTAL (ACE Unit)	Multi	1 - West	PATIENT REPRESENTATIVE	3	GF
ENT	Multi	5 - West	PAY OFFICE	68	1
EYE	41		PHARMACEUTICAL SUPPLY SERVICE	75	
GASTROENTEROLOGY	Multi	1 - West	PHARMACY / PRESCRIPTIONS	3	GF
IMMUNOLOGY & INFECTIOUS DISEASES	Multi	6- West	PHARMACY - Oncology	Multi	GF - East
MEDICAL CENTRE CLINICS	2		PHYSIOTHERAPY (MAIN)	30	
NEUROSCIENCES & NEUROPHYSIOLOGY	Multi	5 - West	PHYSIOTHERAPY & REHABILITATION	30	
ORTHOPAEDIC & RHEUMATOLOGY	Multi	6 - West	PSYCHIATRY CONSULT LIAISON	B2	L2
PLASTICS & BURNS	Multi	7 - North	PSYCHOLOGY	43	
PODIATRY (Diabetic)	2	5	PULMONARY REHABILITATION	88	
PODIATRY (Community)	30		Prayer Room	Multi	L6 - West
PRE ADMISSION CLINIC (Medical Centre Level 4)	2	4	Q		
RESPIRATORY	Multi	7 - West	QUALITY IMPROVEMENT UNIT	75	1
SPEECH PATHOLOGY	42		R		
SPORTS MEDICINE	87		RADIOLOGY	3	1
STOMAL THERAPY	Multi	1 - West	RED CROSS THEATRE	32	
UROLOGY & PROSTATE	Multi	4 - West	REHABILITATION, AGED CARE & MEDICINE PRECINCT	10 to 19	
VASCULAR	Multi	3 - West	RESEARCH & DEVELOPMENT OFFICE	75	1
D			RESIDENTIAL QUARTERS	75	
DAY OF SURGERY ADMISSIONS CENTRE (DOSAC)	Multi	2 - West	RESPIRATORY FUNCTIONS LABORATORY	Multi	7 - West
DEMENTIA SUPPORT SERVICE	19		RHEUMATOLOGY DEPARTMENT	Multi	6 - West
DEPARTMENT OF MEDICINE	20		RMO LOUNGES	75	
DEPARTMENT OF SURGERY	Multi	GF - West	RSL REPRESENTATIVE	2	7
DIABETES EDUCATION CENTRE	2	5	RURAL SURGICAL ENHANCEMENT PROGRAM	36	
DIAGNOSTIC PATHOLOGY UNIT (DPU)	Multi	GF - West	S		
DIETETICS & NUTRITION	38		SECURITY	1	
DISCHARGE LOUNGE	7		SLEEP STUDIES UNIT	Multi	6 - East
DRUG HEALTH SERVICES	64,65 & 73		SOCIAL WORK DEPARTMENT	39 & 40	
E			STAFF OCCUPATIONAL HEALTH CENTRE	22	
EMERGENCY DEPARTMENT	3	LGF	STERILISING SERVICES	3	3-South
EMPLOYMENT ASSISTANCE PROGRAM	36		SWITCHBOARD	4	
ENDOCRINOLOGY LABS	29		SATELLITE DIALYSIS DAY UNIT	3	B2
ENGINEERING SERVICES OFFICE	75	LGF	SECURITY STAFF ID	LG	B5
ENGINEERING SERVICES WORKSHOPS	74		T		
ENVIRONMENTAL SERVICES	72		TRANSPORT SERVICES	83	
EQUIPMENT LOAN POOL	21		V		
EXECUTIVE UNIT	3	GF	VETERAN DAY CENTRE	69	
F			VETERAN & WAR WIDOW LIAISON	2	GF
FINANCE	68	GF	VOLUNTEER SERVICES	8	
FLAMMABLE STORE (Next to Bldg 68)			WARDS		
FLORIST	3	GF	AGED & EXTENDED CARE (AECD)	10	
FOOD SERVICES	Multi	LGF - North	AGED & EXTENDED CARE (AECD) DAY HOSPITAL	16	
FUNDRAISING & MARKETING OFFICE	8B		BURNS UNIT	Multi	7
G			COLORECTAL & GASTROENTEROLOGY	Multi	1 - East
VACANT	7		CORONARY CARE UNIT & RADIOLOGY	Multi	3 - East
H			INTENSIVE CARE UNIT & HDU	Multi	2 - North
HAEMODIALYSIS UNIT	Multi	4 - North	MEDICAL GERIATRICS & REHABILITATION	11 & 15	
HAEMATOLOGY AMBULATORY CARE UNIT (HACU)	Multi	GF - East	NEUROSCIENCES	Multi	5 - North
HOSTEL - PATIENT & GUESTS	75	3	ONCOLOGY	Multi	5 - East
HUMAN RESOURCES DEPARTMENT	68	GF	ORTHOPAEDICS	Multi	6 - North
HUMAN RESOURCES DEVELOPMENT CENTRE (Training Rm)	33		PSYCHOGERIATRICS	17	
HAND THERAPY CLINIC	2	L1	RENAL / VASCULAR / RADIOLOGY	Multi	3 - North
			RENAL / VASCULAR	Multi	4 - North
			RESPIRATORY	Multi	6 - East
			UPPER GIT & GASTROENTEROLOGY	Multi	1 - North
			UROLOGY / PLASTICS / BREAST / DERMATOLOGY	Multi	4 - East
			X		
			X-RAY DEPARTMENT	3	1

WARDS

AGED & EXTENDED CARE (AECD)	10	
AGED & EXTENDED CARE (AECD) DAY HOSPITAL	16	
BURNS UNIT	Multi	7
COLORECTAL & GASTROENTEROLOGY	Multi	1 - East
CORONARY CARE UNIT & RADIOLOGY	Multi	3 - East
INTENSIVE CARE UNIT & HDU	Multi	2 - North
MEDICAL GERIATRICS & REHABILITATION	11 & 15	
NEUROSCIENCES	Multi	5 - North
ONCOLOGY	Multi	5 - East
ORTHOPAEDICS	Multi	6 - North
PSYCHOGERIATRICS	17	
RENAL / VASCULAR / RADIOLOGY	Multi	3 - North
RENAL / VASCULAR	Multi	4 - North
RESPIRATORY	Multi	6 - East
UPPER GIT & GASTROENTEROLOGY	Multi	1 - North
UROLOGY / PLASTICS / BREAST / DERMATOLOGY	Multi	4 - East
X		
X-RAY DEPARTMENT	3	1